

INSTRUCTIONS FOR USE

BEFORE USING THE APPLIANCE

SAFEGUARDING THE ENVIRONMENT

**PRECAUTIONS AND GENERAL
RECOMMENDATIONS**

**PRECAUTIONS AND GENERAL
RECOMMENDATIONS**

**HOW TO OPERATE THE LOW TEMPERATURE
COMPARTMENT**

**HOW TO DEFROST AND CLEAN THE
REFRIGERATOR**

CARE AND MAINTENANCE

TROUBLESHOOTING GUIDE

AFTER-SALES SERVICE

INSTALLATION

TOP REMOVABLE

ELECTRICAL CONNECTION

BEFORE USING THE APPLIANCE

- Your new appliance is designed exclusively for domestic use.

To get the most out of your new appliance, read the user handbook carefully. It contains a description of the appliance as well as useful tips.

Keep this handbook for future consultation.

1. After unpacking the appliance, make sure that it is undamaged and that the doors close correctly. Any damage must be reported to the dealer within 24 hours of delivery of the appliance.
2. Wait at least two hours before switching the appliance on, to ensure that the refrigerant circuit is fully efficient.
3. Installation of the appliance and electrical connections must be carried out by a qualified electrician, in accordance with the manufacturer's instructions and local safety regulations.
4. Clean the inside of the appliance before use.

SAFEGUARDING THE ENVIRONMENT

1. Packaging

The packaging material is 100% recyclable and carries the recycling symbol. Follow local regulations for scrapping.

Keep packing materials (plastic bags, polystyrene parts, etc.) out of the reach of children, as they are a potential source of danger.

2. Scrapping/Disposal

The appliance is manufactured using recyclable material.

This appliance is marked according to the European directive 2002/96/EC on Waste Electrical and Electronic Equipment (WEEE). By ensuring that this appliance is scrapped suitably, you can help prevent potentially damaging consequences for the environment and health.

The symbol  on the appliance, or on the accompanying documents, indicates that this appliance should not be treated as domestic waste but must be taken to a special collection centre for the recycling of electrical and electronic equipment.

When scrapping the appliance, make it unusable by cutting off the power cable and removing the doors and shelves so that children cannot easily climb inside and become trapped. Scrap the appliance in compliance with local regulations on waste disposal, taking it to a special collection centre; do not leave the appliance unattended even for a few days, since it is a potential source of danger for children. For further information on the treatment, recovery and recycling of this product, contact your competent local office, the household waste collection service or the shop where you purchased the appliance.

Information:

This appliance does not contain CFCs.

The refrigerant circuit contains R134a (HFCs) or R600a (HCs), see the rating plate inside the appliance.

Appliances with isobutane (R600a): Isobutane is a natural gas of low environmental impact. Caution is required, however, since isobutane is flammable. Therefore, ensure that refrigerant circuit pipelines are not damaged.

Declaration of conformity

This product has been designed for preserving food and is manufactured in compliance with Regulation (CE) No. 1935/2004.



This product has been designed, manufactured and marketed in compliance with:

- the safety objectives prescribed in the Low Voltage Directive 2006/95/CE (which replaced Directive 73/23/CEE as amended);
- the protection requirements of the "EMC" 89/336/CEE directive, amended by Directive 93/68/CEE

Electrical safety of the appliance can only be guaranteed if it is correctly connected to an approved earthing system.



PRECAUTIONS AND GENERAL RECOMMENDATIONS

- The appliance must be handled and installed by two or more persons.
- Be careful not to damage the floors when you move the appliance (e.g. parquet flooring).
- During installation, make sure the appliance does not damage the power cable.
- Check the appliance is not positioned near a heat source.
- To guarantee adequate ventilation, leave a space on both sides and above the appliance and follow the installation instructions.
- Keep the appliance vent outlets free.
- Do not damage the appliance refrigerant circuit pipes.
- Install and level the appliance on a floor strong enough to take its weight and in a place suitable for its size and use.
- Install the appliance in a dry and well ventilated area. The appliance is intended for operation in environments where ambient temperatures fall within the following ranges, depending on the climatic class indicated on the data plate. The appliance may not work properly if it is left for a long time at a temperature outside the specified range.

Climatic Class	Amb. temp. (°C)	Amb. temp. (°F)
SN	From 10 to 32	From 50 to 90
N	From 16 to 32	From 61 to 90
ST	From 16 to 38	From 61 to 100
T	From 16 to 43	From 61 to 110

- Ensure that the voltage indicated on the appliance data plate corresponds to the domestic supply voltage.
- Do not use single/multiple adapters or extension cables.
- For the water connection, use the pipe supplied with the new appliance; do not reuse the one from the previous appliance.
- Power cable modification or replacement must only be carried out by qualified personnel.
- Electrical disconnection must be possible either by unplugging the appliance or by means of a double-pole switch located upline from the socket.

SAFETY

- Do not store or use petrol, flammable liquids or gas in the vicinity of this or other electrical appliances. The fumes can create a fire hazard or explosion.
- Do not use mechanical, electric or chemical means other than those recommended by the Manufacturer to speed up the defrost process.
- Do not use or place electrical appliances inside the product if they are not of the type expressly authorised by the Manufacturer.
- The appliance is not intended for use by persons (children included) with restricted physical, sensory or mental abilities or without experience and knowledge of the appliance, unless they are under the supervision or instruction of a person responsible for their safety. Do not allow children to play or hide inside the appliance - risk of becoming trapped and suffocating.
- Do not swallow the contents (non-toxic) of the ice packs (in some models).
- Do not eat ice cubes or ice lollies immediately after taking them out of the freezer since they may cause cold burns.

USE

- Before carrying out any maintenance or cleaning, always unplug the appliance or disconnect the power supply.
- All appliances equipped with ice-makers and water dispensers must be connected to a water supply that only delivers potable water (with mains water pressure of between 0.17 and 0.81 MPa (1.7 and 8.1 bar)). Ice makers and/or water dispensers not directly connected to the water mains must be filled using potable water only.
- Use the refrigerator compartment to store fresh food only and the freezer compartment to store frozen food, to freeze fresh food, and to make ice cubes only.
- Do not store glass containers with liquids in the freezer since they may burst.

The Manufacturer declines any liability if the above advice and precautions are not respected

HOW TO OPERATE THE REFRIGERATOR COMPARTMENT

Switching on the appliance

Starting up the appliance

The appliance features internal controls.

Plug in the appliance.

When the appliance is connected to the mains, the inside light switches on each time the door is opened. The thermostat, located inside the refrigerator compartment, is used to adjust the temperature of both the refrigerator compartment and low temperature compartment (if fitted).

Appliance temperature adjustment:

The thermostat automatically adjusts the temperature inside the refrigerator compartment and the ***C*** compartment.

The thermostat knob can be turned from position **1** to **7** (coldest setting) to make the internal temperature colder.

When set to **0** the appliance is switched off.

To store food for a short period of time, set the thermostat between **1 (Min)** and **3 (Med)**.

- To store food for long periods of time in the ***C*** compartment, set the thermostat to **3** or **4**.



Note:

The ambient air temperature, frequency of door opening and the position of the appliance can affect internal temperatures. These factors must be taken into account when setting the thermostat.

How to use the refrigerator compartment

Position the food as shown in the figure.

- A Cooked food
- B Fish, meat
- C Fruit and vegetables
- D Bottles
- E Cheese

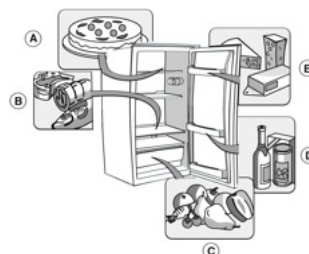

Notes:

- The space between the shelves and the rear wall of the refrigerator compartment must be unobstructed to allow circulation of air.
- Do not place food in direct contact with the rear wall of the refrigerator compartment.
- Do not place hot food in the refrigerator.
- Store liquids in closed containers.

Important

Storing vegetables with high water content can cause condensation to form on the glass shelf of the crisper drawer: this will not affect the correct operation of the appliance.

HOW TO OPERATE THE LOW TEMPERATURE COMPARTMENT

The low temperature compartment is . Frozen food can be stored in the compartment for the period of time indicated on the pack, and also fresh food can be frozen.

The quantity of fresh food that can be frozen in 24 hours is shown on the rating plate.

Note:

In the event of a power cut, the low temperature compartment will maintain a sufficiently low temperature for food storage. However, it is advisable to avoid opening the compartment door during such periods.

Freezing fresh food (only in compartments marked)

- Before freezing, wrap and seal fresh food in: aluminium foil, cling film, air and water-tight plastic bags, polythene containers with lids or freezer containers suitable for freezing fresh food.
- Arrange the fresh food in the top compartment, leaving sufficient space around each pack for the air to circulate.
- For optimum freezing, turn the thermostat down by half a point when placing fresh foods in the freezer compartment.
- The food will be completely frozen in 24 hours.

For appliances with compartments marked

The table alongside shows the recommended maximum storage time for frozen fresh foods.

When purchasing frozen food products:

- ensure that the packaging is not damaged (frozen food in damaged packaging may have deteriorated). If the package is swollen or has damp patches, it may not have been stored under optimal conditions and defrosting may have already begun.
- When shopping, leave frozen food purchases until last and transport the products in a thermally insulated cool bag.
- Place the items in the low temperature compartment as soon as you get home.
- If food has defrosted even partially, do not re-freeze it. Consume within 24 hours.
- Avoid, or reduce temperature variations to the minimum. Respect the best-before date on the package.
- Always observe the storage information on the package.

Making ice cubes

- Fill the ice cube tray 2/3 full and place it in the low temperature compartment
- Do not use sharp or pointed instruments to detach the tray if it is stuck to the low temperature compartment bottom.
- Bend the ice tray slightly to remove the cubes.

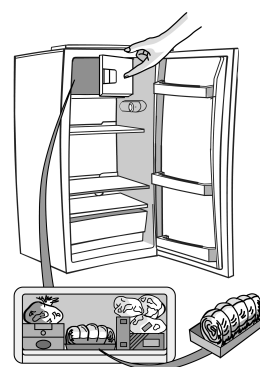

MONTHS	FOOD		
1-3			
4-7			
8-12			

HOW TO DEFROST AND CLEAN THE REFRIGERATOR

Before any cleaning or maintenance operation, unplug the appliance from the mains or disconnect the electrical power supply.

Defrosting of the refrigerator compartment is completely automatic.

Droplets of water on the rear wall of the refrigerator compartment indicate that the periodic automatic defrost cycle is in progress.

The defrost water is automatically routed to a drain outlet and into a container from which it evaporates.

Regularly clean the inside of the defrost water drain hole in order to guarantee the constant and correct flow of defrost water.

Defrosting the low temperature compartment

Defrost the low temperature compartment once or twice a year or when the ice formation is excessive.

It is perfectly normal for ice to form. The amount of ice which forms and the rate at which it accumulates will depend on room temperature and humidity, and on the frequency with which the door is opened. Ice formation is concentrated at the top of the compartment and does not affect the efficiency of the appliance.

If possible, defrost the freezer when it is nearly empty.

- Remove the food from the freezer, wrap in newspaper and group together in a cool place or in a portable cooler.
- Leave the door open to allow the frost to melt.
- **Clean the interior with a sponge soaked in warm water and/or neutral detergent. Do not use abrasive substances.**
- Rinse the interior and dry thoroughly.
- Put the food back into the freezer.
- Close the door.
- Plug in the appliance once again.
- Switch the appliance on.

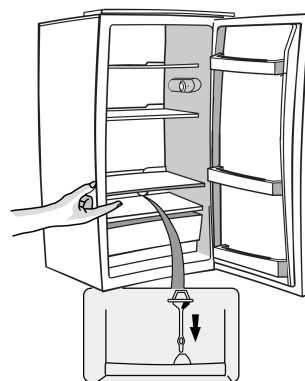

CARE AND MAINTENANCE

- Periodically clean air vents and the condenser at the rear of the appliance with a vacuum cleaner or a brush.
- Clean the outside using a soft cloth.

Prolonged disuse

1. Empty the refrigerator.
 2. Disconnect the appliance from the power supply.
 3. Defrost and clean the interior.
 4. In the event of prolonged disuse, leave the door open to prevent the formation of mould, odours and oxidation.
 5. Clean the appliance.
- Clean the inside of the low temperature compartment (where fitted) when defrosting.
 - Periodically clean the inside of the refrigerator compartment with a sponge dampened in warm water and/or neutral detergent. Rinse and dry with a soft cloth. Do not use abrasive products.
 - Clean the outside with a soft damp cloth.
- Do not use abrasive products, scourers, stain-removers (e.g. acetone, trichloroethylene) or vinegar.

Replacing bulbs:

When replacing the bulb, proceed as follows:

- Unplug the appliance from the mains
- Squeeze the tabs on the sides of the lamp cover and remove it.
- Replace the bulb with a new one, maximum 10 W.
- Put the lamp cover back on and wait 5 minutes before plugging the appliance back into the mains.

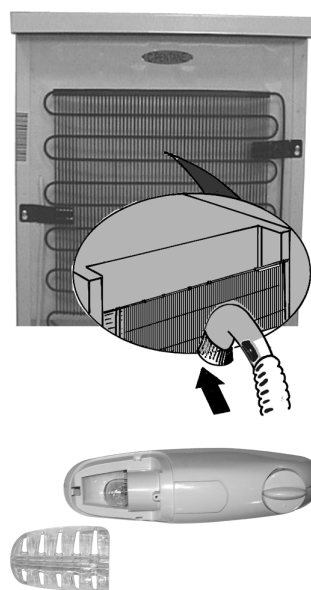

TROUBLESHOOTING GUIDE

When you hear these noises

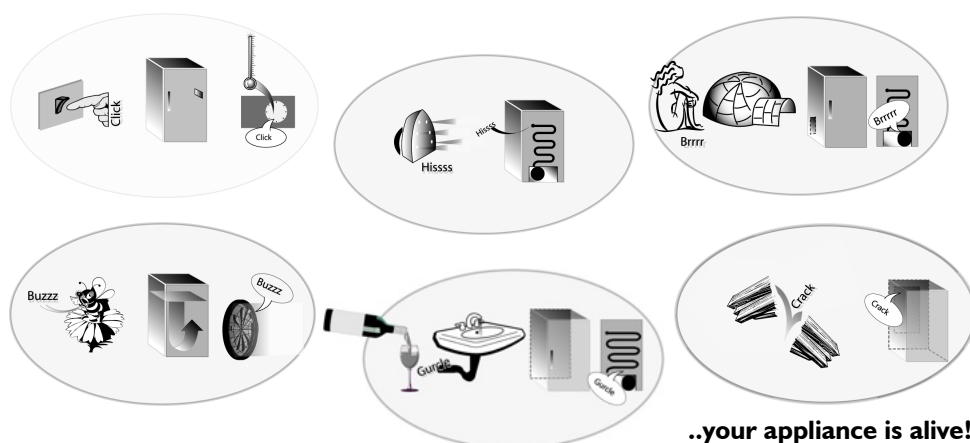

..your appliance is alive!!!

1. The appliance is not working.

- Is there a power failure?
- Is the plug properly inserted in the socket?
- Is the double-pole switch on?
- Has the fuse blown?
- Is the power cord damaged?
- Is the thermostat set to ● (Stop)?

2. Temperature inside the compartments is not low enough.

- Is the door shut properly?
- Is food obstructing proper door closure?
- Is the appliance installed near a heat source?
- Is the thermostat setting correct?
- Are the air circulation vents blocked?

3. Temperature inside the refrigerator compartment is too low.

- Is the thermostat setting correct?

4. The appliance is excessively noisy.

- Has the appliance been installed correctly?
- Are the pipes at the back touching or vibrating?

5. Water collects at the bottom of the refrigerator compartment.

- Is the defrost water drain blocked?

6. Excessive frost build-up in the low temperature compartment.

- Is the door shut properly?
- Is food obstructing proper door closure?

Notes:

- Gurgling and hissing noises due to expansion in the refrigerant circuit are normal.

AFTER-SALES SERVICE

Before contacting After-Sales Service:

1. See if you can solve the problem yourself with the help of the "Troubleshooting guide").
2. Switch the appliance on again to see if the problem has been solved. If it has not, disconnect the appliance from the power supply and wait for about an hour before switching on again.
3. If the problem persists after this course of action, contact After-sales Service.

Specify:

- the nature of the problem
- the model
- the Service number (the number after the word SERVICE on the rating plate on the inside of the appliance)
- your full address
- your telephone number and area code.

SERVICE 0000 000 00000



INSTALLATION

- Install the appliance away from heat sources. Installation in a hot environment, direct exposure to the sun or installation near heat sources (heaters, radiators, cookers) will increase power consumption and should therefore be avoided.
- If this is not possible, the following minimum distances must be respected:
 - 30 cm from coal or paraffin stoves;
 - 3 cm from electric and/or gas stoves.
- Fit the spacers (if supplied) on the rear of the condenser positioned at the back of the appliance (see figure).
- To optimize appliance efficiency, leave a 5 cm gap above the appliance and make sure that adjacent kitchen units are sufficiently distanced to allow air circulation.
- Install the appliance in a dry, well-ventilated place, and ensure it is level, using the front adjustment feet if necessary.
- Clean the interior.
- Fit the accessories.

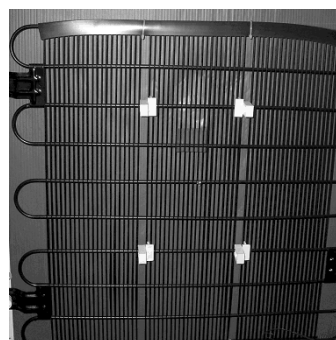

Electrical connection

- Electrical connections must be made in accordance with local regulations.
- Voltage and power consumption are indicated on the rating plate inside the appliance.
- Regulations require that the appliance is earthed.
The Manufacturer declines all liabilities for injury to persons or animals or damage to property resulting from failure to observe these regulations.
- If the plug and socket are not of the same type, have the socket replaced by a qualified electrician.
- Do not use extension leads or adapters.

Disconnecting the appliance

It must be possible to disconnect the appliance by unplugging it or by means of a two-pole switch fitted upline of the socket.

Door Swing Reversal

Reversing the door swing

The refrigerator has the capability of opening the door from either the left or the right side.

The unit is delivered to you with the door opening from the left side. To change the opening direction, please follow these instructions.

Note: Before reversing the door swing, unplug the appliance from the mains or disconnect the electrical power supply.

1. Remove the screws (6) holding the top panel (7) to the unit. Remove the top panel.
2. Remove the two screws (1) holding the top hinge (5) (right side) to the frame. Remove the top hinge (5).
3. Lift the door off the bottom hinge pin and place it on a non-scratching surface.
4. Remove the two screws (8) holding the bottom hinge (2).
5. Remove the left front leg (4) and transfer it to the right side.
6. Before replacing the bottom hinge (2), remove the hinge pin (9) and reverse the direction of the hinge (2). Reassemble the bottom hinge (2) on the left hand side using the two screws (8).
7. Refit the hinge pin (9) into the bottom hinge (2).
8. Lower the door onto the bottom hinge pin (9).
9. While holding the door in the closed position, reassemble the top hinge (5) on the left hand side using the two screws (1). Do not tighten the screws (1) until the top of the door is level with the counter top.
10. Refit the top panel using the screws (6).

Note:

The direction of door opening can be changed.
If this operation is performed by After-sales Service it is not covered by the warranty.

Reversing the Inside Compartment Door Swing

1. Remove the door support pin screw at the bottom right;
2. remove the cap on the left part;
3. remove the two screw caps on the left part;
4. undo the two screws;
5. refit everything on the opposite side.

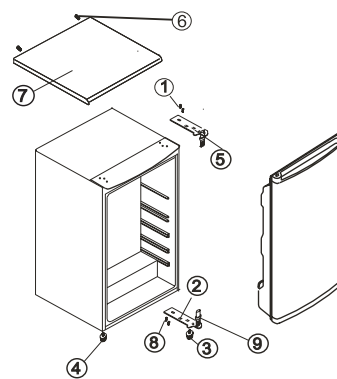

Door opening from left side fig. 1

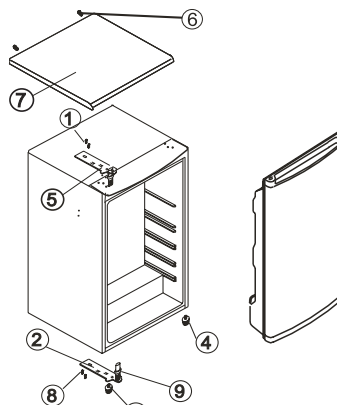

Door opening from right side fig. 2

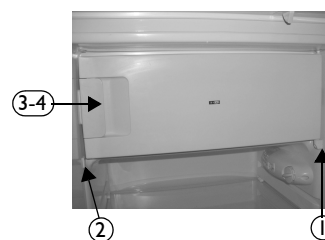

TOP REMOVABLE

REFRIGERATION TABLE TOP 54 CM

HOW TO REMOVE THE TOP BEFORE TO PLACE THE APPLIANCE IN BUILT IN POSITION

Operation n°1

To dismount the 2 screws on the back side of the product

Operation n°2

To lift up from rear the top, and remove it from front fixation

Operation n°3

To dismount the 10 screws on the front plastic frame and metal hinge

Operation n°4

To move out the hinge and the plastic frame

Operation n°5

To replace and to refit the metallic hinge with 2 screws



screws

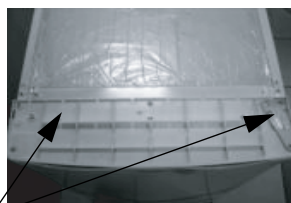

screws



screws



ELECTRICAL CONNECTION

1) For Great Britain only

Warning - this appliance must be earthed

Fuse replacement

If the mains lead of this appliance is fitted with a BS 1363A 13amp fused plug, to change a fuse in this type of plug use an A.S.T.A. approved fuse to BS 1362 type and proceed as follows:

1. Remove the fuse cover (A) and fuse (B).
2. Fit replacement 13A fuse into fuse cover.
3. Refit both into plug.

Important:

The fuse cover must be refitted when changing a fuse and if the fuse cover is lost the plug must not be used until a correct replacement is fitted.

Correct replacement are identified by the colour insert or the colour embossed in words on the base of the plug.

Replacement fuse covers are available from your local electrical store.

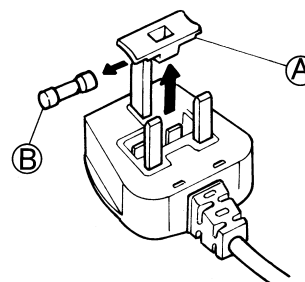

2) For the Republic of Ireland only

The information given in respect of Great Britain will frequently apply, but a third type of plug and socket is also used, the 2-pin, side earth type.

3) Socket outlet / plug (valid for both countries)

If the fitted plug is not suitable for your socket outlet, please contact Whirlpool Service for further instruction. Please do not attempt to change plug yourself. This procedure needs to be carried out by a qualified Whirlpool technician in compliance with the manufactures instructions and current standard safety regulations.